

# Teaching the Miracle at the 27<sup>th</sup> Parallel

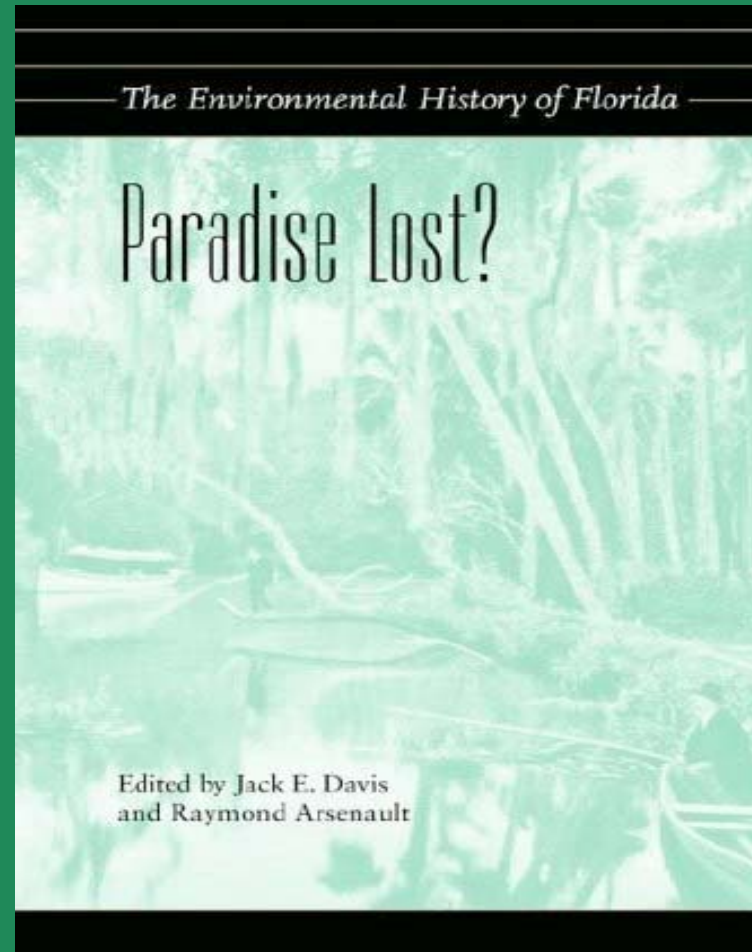



# Paradise Lost?



## John Dewey Chair, 1931 Rollins Colloquy on the Liberal Arts

- *Experience outside the school has its geographical aspect, its artistic and its literary, its scientific and its historical sides. All studies arise from aspects of the one earth and the one life lived upon it.*
- *Educating global citizens for social responsibility*
  - *Rollins College 2007*

# Pass the Test, Keep the Planet

## EVERGLADES RESTORATION *Stepping Up the Pace*

**Invested:** \$1.3 billion already invested to clean up and restore the River of Grass; \$3.2 billion committed through the end of the decade, including \$1.7 billion to accelerate critical projects.



**Acquired:** 193,514 acres - more than 87 percent of the land needed for the initially authorized projects.

**Accelerated:** Eight critical Everglades restoration projects by a decade; 92 percent of the land acquired to complete the Acceler8 projects.

**Completed:** 41,000 acres of constructed wetlands to clean the water flowing into the Everglades.

**Exceeding Expectations:** Advanced water quality technologies prevented 2,178 tons of phosphorus from entering the Everglades.

Comprehensive Everglades Restoration Plan Funding

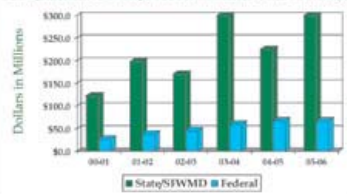

Source: Florida Department of Environmental Protection



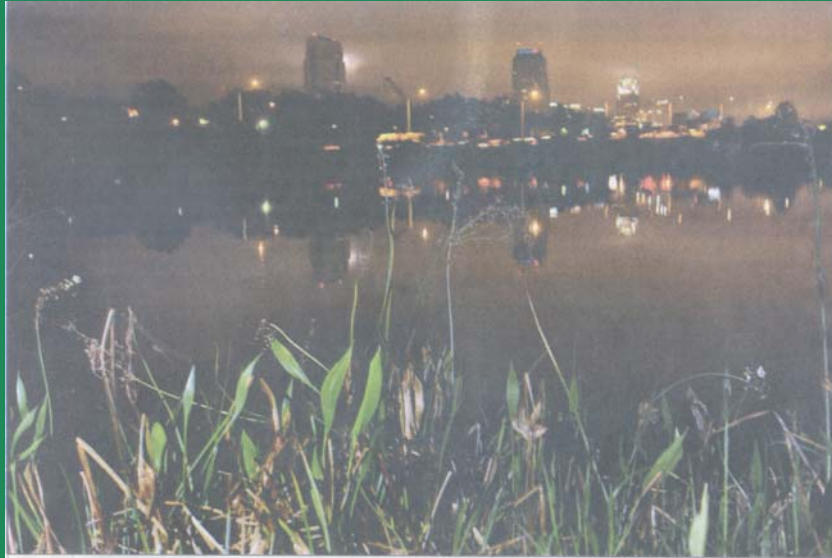

GEORGE SKENE/ORLANDO SENTINEL

Downtown lights reflect in Lake Concord. The public is invited to a free session Saturday about Everglades activism.

# Everglades pollution starts here

Orlandoans are partly responsible for the future of the endangered ecosystem, and for how tainted it becomes.

By KEVIN SPEAR  
SENTINEL STAFF WRITER

The Seven Seas Lagoon at Walt Disney World offers more adventure than visitors might know.

So do Lake Lorna Doone just below the lip of the Citrus Bowl stadium, Lake Conway at the south edge of Orlando and Lake Nona next to Orlando International Airport.

Perhaps a surprise to even the area's longtime residents, waters that drain from those lakes journey nearly 200 miles to the Everglades. They are part of a mosaic of ditches, canals, streams, wetlands and lakes across south Orange County that constitute the headwaters of Florida's famed but imperiled environmental treasure.

To draw attention to that connection, the 39-year-old Everglades Coalition this Thursday through Sun-

## PHOTO EXTRA

For a gallery, 'Orlando — Headwaters for the Everglades,' and more, see [OrlandoSentinel.com/florida](http://OrlandoSentinel.com/florida)



day will bring its annual conference to the Orlando area for the first time. The nearly 50 environmental groups in the organization want to raise awareness that recovery of the ailing ecosystem depends in large part on what happens in Central Florida and even just blocks from the city's downtown office towers.

"Pollutants getting into the headwaters ultimately are going to make their way to the Everglades," said Mark Perry, executive director of the Florida Oceanographic Society in Stuart and a conference organizer.

Upper reaches of the Everglades ecosystem form

PLEASE SEE **EVERGLADES, D4**

# Landscape Restoration: Common Sense Education

In 1932, President **Hamilton Holt** invited **John Nolen** to Rollins to experience the college's "**Great Adventure in Common Sense Education**"



*W. P. 3—Genius Drive, Winter Park, Fla.*

# The Arboretum

University of Wisconsin-Madison







DEDICATION  
 OF THE  
 UNIVERSITY OF WISCONSIN  
 ARBORETUM  
 AND  
 WILD LIFE REFUGE  
 9:30 A.M. JUNE 17<sup>th</sup> 1934  
 SPEAKERS

FOR THE REGENTS	FRED H. CLAUSEN
FOR THE UNIVERSITY	GLENN FRANK
FOR THE STATE	RALPH IMMEL
THE ARBORETUM	G. W. LONGENECKER
THE REFUGE	ALDO LEOPOLD
RESEARCH	HARRY L. RUSSELL
THE FUTURE	JOHN NOLEN



*To recognize the scientific, practical, and aesthetic value of the beautiful, open-air laboratories that have proved so useful in other places, 1911*



# Light my Fire



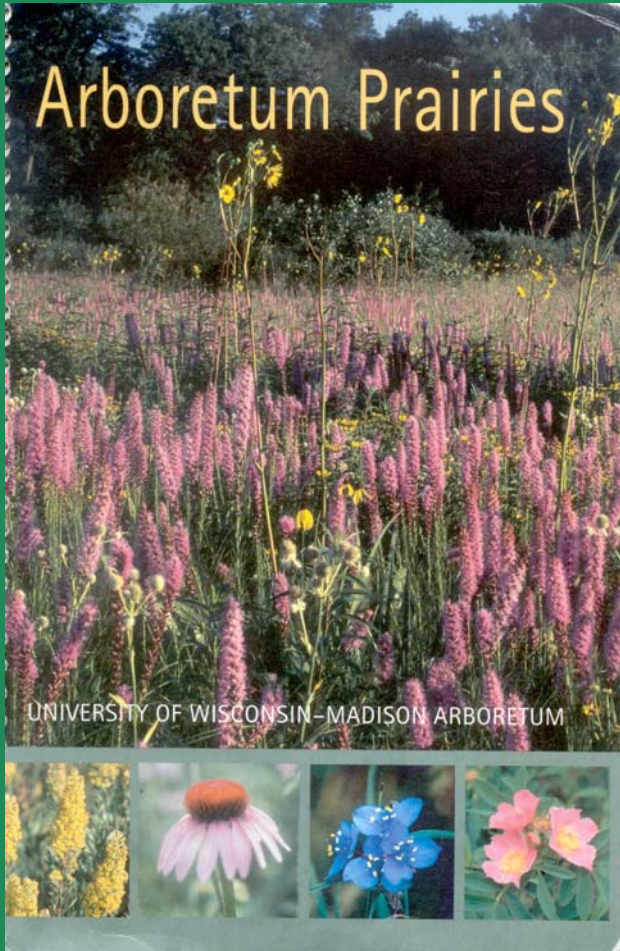

# UWA Model Working Laboratory



To teach the student to see the land, to understand what they see, and enjoy what they understand

# Living Laboratory



# Paradise Found



## Initial Inventory: categories



Ecological  
Restoration

Garden

Grove

Ward House

Paths

Buffers

Drive





# Restoration



Progress



# Cedar Grove





# Planning

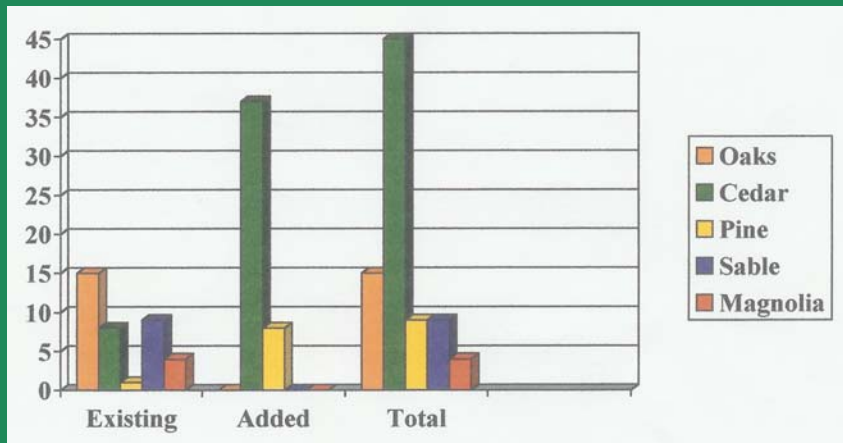

# Design

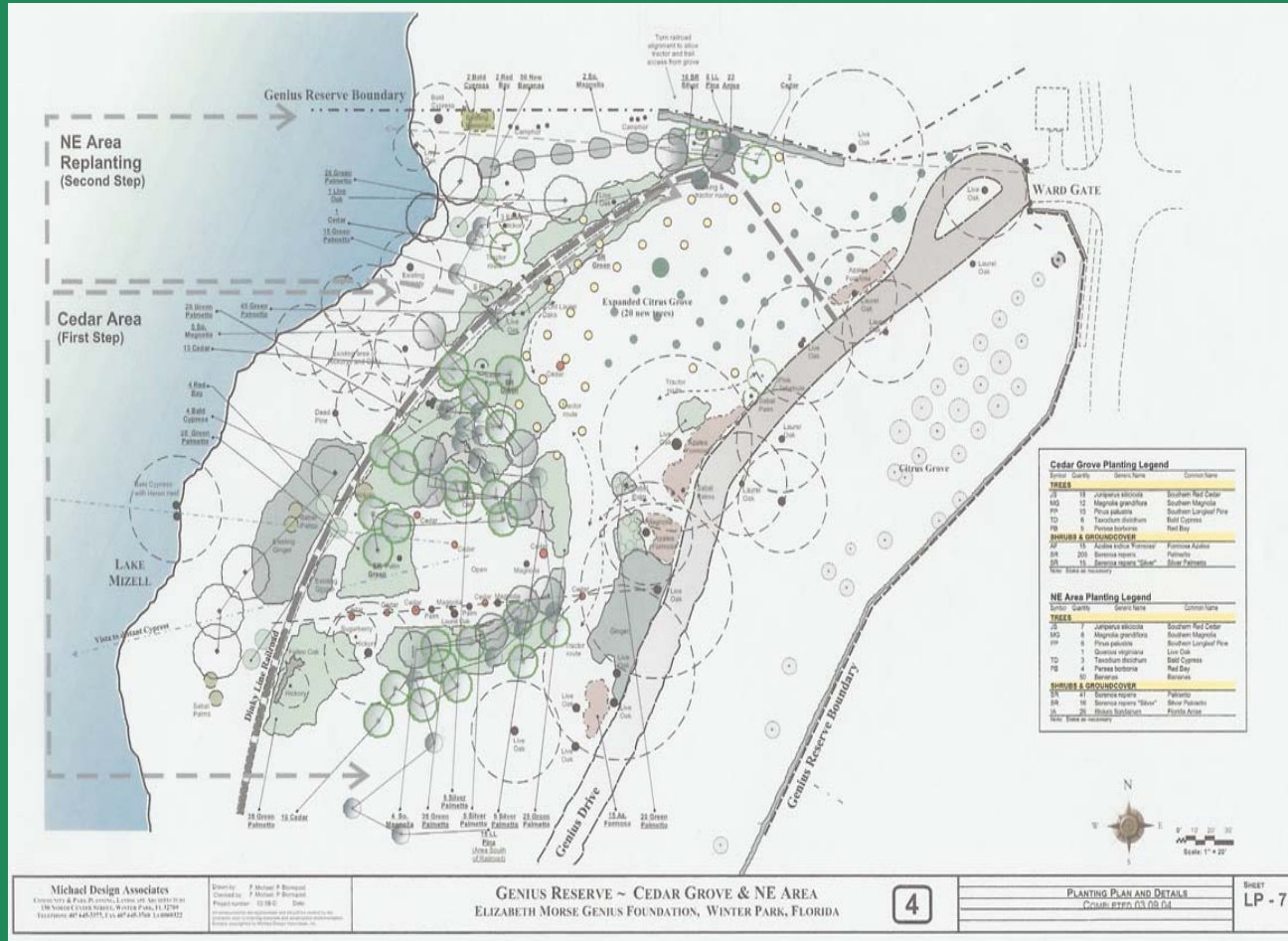

Michael Design Associates  
 1800 South Orange Avenue, Winter Park, FL 32789  
 Telephone: 407-445-3773, 1-800-445-3748, 1-800-445-3772

Drawn by: P. Benson  
 Checked by: P. Benson  
 Project Number: 021801 Date:

GENIUS RESERVE ~ CEDAR GROVE & NE AREA  
 ELIZABETH MORSE GENIUS FOUNDATION, WINTER PARK, FLORIDA

4

PLANTING PLAN AND DETAILS  
 CONSULT: 021801, 03, 08, 04

SHEET  
 LP - 7

<i>Prunus umbellata</i>	Flatwood plum	11	\$6.50 (small)	\$40.00	\$440.00
<i>Diospyros virginiana</i>	Persimmon	11	\$5.00 (small)		\$55.00
<i>Vaccinium angustifolium</i>	Blueberry	41	\$6.50		\$266.50
	Sumac	11	\$6.50		\$71.50
<i>Morus rubra</i>	Mulberry	41	\$6.50		\$266.50
	Elderberry	11	\$6.50		\$71.50
<i>Zamia pumila</i>	Coontie	62	\$11.50		\$713.00
<i>Erythrina herbacea</i>	Coral Bean	30	\$6.50		\$195.00
	Native Coffee	30	\$6.50		\$195.00
<i>Serenoa repens</i>	Saw palmetto	26	about \$10.00		\$260.00
	Red bay	10	about \$40.00		\$400.00
<i>Magnolia grandiflora</i>	Southern magnolia	32	about \$40.00		\$1,280.00
	Red Cedar	32	about \$40.00		\$1,280.00
Bench-engraved	Bench-engraved	4	\$295		\$1,180.00
Arch	Arch	1	\$500		\$500.00
Bench-camphor	Bench-camphor	5	free		\$0.00
<i>Butterfly Plants</i>	Butterfly Plants	52	\$5.00		\$260.00
<i>Pinus palustris</i>	Long-leaf Pine	3	about \$40.00		\$120.00





# Rollins Labor



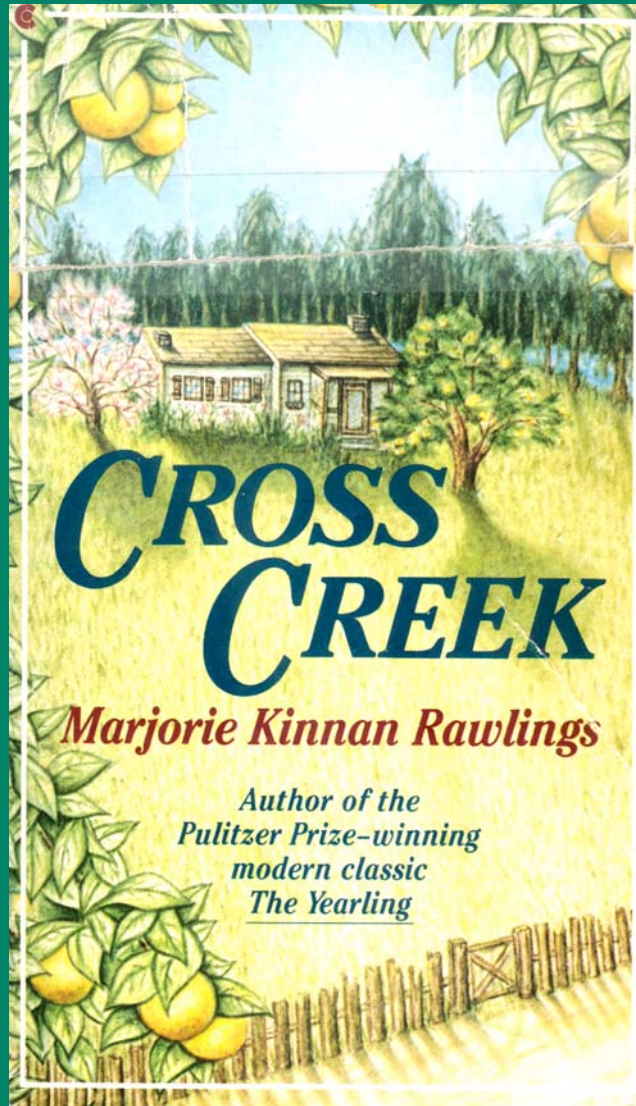

## Ward House



# Marjorie Rawlings & President Holt



# Orange Gold

*"The road curves sharply the vegetation thickens and around the masses into dense hammock the hammock breaks, is pushed back on either side of the road, in set down in its brooding heart is the orange grove"*



Marjorie Rawlings



The Rawlings' Home at  
Cross Creek



— Marjorie Rawlings  
• (Cross Creek)













# The Natural Setting

## The Creation of a Buffer

- Bringing Cross Creek to the Genius Reserve
  1. Foundation purchased adjacent lot straighten the boundary line, creating a more esthetic scene
  2. Reestablishing native species and removing invasive species.
  3. Investing in design



View at Cross Creek



View from the Ward House at the Genius Reserve



# Native Species

- Bald Cypress

- (*Taxodium distichum*)



- Southern Red Cedar

- (*Juniperus*)

*Coontie was traditionally used in Florida as a source of flour*

- Southern Magnolia

- (*Magnolia*)

- Live Oak

- (*Quercus*)



- Slash Pine

- (*Pinus palustris*)



- Cabbage Palm

- (*Sabal palmetto*)



- Coontie

- (*Zamia floridana*)



- Saw Palmetto

- (*Serenoa repens*)



Victory







## Rollins Students and Faculty hard at work in the Genius Reserve

